



D8+ TÜV CERTIFIED

Xscell

ELECTRIC CHAIN HOIST

CAPACITIES
1/2 -1 ton

LIFT
82 feet +

SPEED
13 feet/min

VOLTAGES
208 ~230V-60HZ-3PH

The model XL 1ton D8+ meets all current standard requirements with 8:1 design factor and double brake. The sealed multi-disc friction clutch is installed between the motor shaft and first-stage gear shaft, upstream of the brake assembly which provides mechanical overload protection by automatically slipping when torque exceeds the calibrated preset threshold.

BENEFITS & FEATURES

IP66 RATING

GST Xscell offers protection from dust and high pressure water, ideal for use in outdoor environments.

CLUTCH

Designed to prevent damage to the hoist by preventing excessive overloads.

5 POCKET LOAD SPROCKETS

Heat treated load sprockets provide hoist smoother and quiet operation.

GEAR TRANSMISSION

Designed for high load capacity, lighter noise and smoother operation.

HEAVY DUTY DUAL DC ELETRIC-MAGNETIC BRAKE

Designed to ensure safety and allow for quick access and easy inspection.

COMPATIBLE CONTROL INTERFACE

Comes with 7 pin motor control and 4 pin XLR plugs for control interface compatibility and low voltage control.

DUTY CYCLE

H4 duty equivalent (M5) rated for heavy duty application. Light H3 available as an option.

ELECTRICAL

Phase reversal protection and motor protection fuse that prevents improper voltage connections.

MECHANICAL EXTERNAL LIMIT SWITCH (UPPER and LOWER)

Quick and easy adjustment and prevents over-travel in both directions at any predetermined point when lifting or lowering.

RATED LOAD CHAIN (BLACK)

EN818-7 with safety factor 8:1. High-strength, heat-treated load chain with corrosion-resistant finish, maintaining full ductility and fatigue resistance for demanding dynamic lifting environments.

ROAD CASE PACKAGED

Convenient to store and travel on the road.

WARRANTY: 18 Month

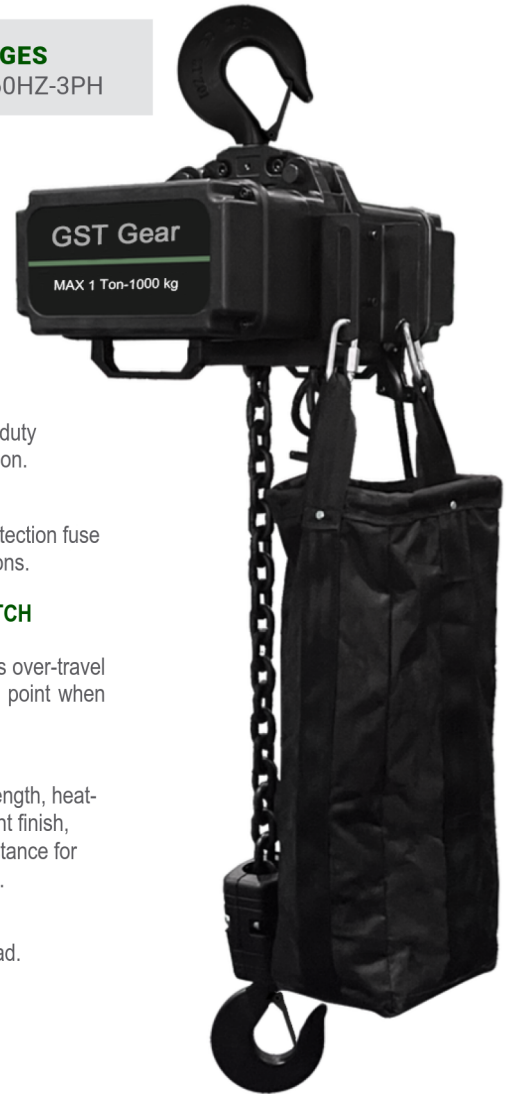

SPECIFICATIONS

Model	Load Capacity Tons (kg)	Lifting Speed fpm (mpm)	Operating Voltage	FEM Class	Chain Weight/Model Length of Lift lb/ft kg/m		Load Chain EN 818-7 in (mm)	Full Load Amps	Reeving	Motor hp (kW)	Protection Class
XL2-10SC	1 (1000)	13 (4)	208-230-3-60	1Bm	0.74	1.10	9/32 (7.1x21)	2.5	1	1 (0.75)	IP66
XL3-10SC	1 (1000)	13 (4)	208-230-3-60	2m	0.95	1.42	>5/16 (8x24)	2.5	1	1 (0.75)	IP66
XLL-05SC	1/2 (500)	13 (4)	208-230-3-60	2m	0.74	1.10	9/32 (7.1x21)	1.5	1	0.5 (0.37)	IP66



Electric Chain Hoist

Model XL D8+

WE PROVIDE and YOU PROFIT!

IP66
classification

D8+
as SQP2

STANDARD
EN14492-2
EN17206
SQP2 2024

D8+ TÜV CERTIFIED

5 POCKET LOAD SPROCKETS

Heat treated load sprockets provide hoist smoother and quiet operation.



LIFTING MOTOR

Aluminum alloy shell, unique heat dissipation system suitable for high frequency operation. Equipped with integrated thermal protection.

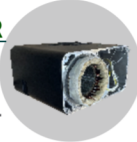

GEAR TRANSMISSION

Designed for high load capacity, lighter noise and smoother operation.



CLUTCH

Designed to prevent damage to the hoist by preventing excessive overloads, installed between the motor shaft and first-stage gear shaft, upstream of the brake assembly.



CONTROL COMPATIBILITY

7 pin motor control and 4 pin XLR

DUAL BRAKE

Designed to ensure safety and allow for quick access and easy inspection. Installed on the first-stage gear shaft for reliable torque transmission. Even in the unlikely event of overload protection failure, the brake system remains fully functional to ensure safe load holding.

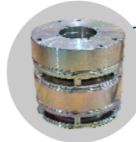

LIMIT SWITCH

Quick and easy adjustment and prevents over-travel in both directions at any predetermined point when lifting or lowering.

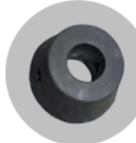

LOAD CHAIN (BLACK)

EN818-7 with safety factor 8:1. Heat-treated with anti-corrosion finish. Engineered for optimal toughness and fatigue performance in dynamic lifting applications.



CHAIN GUIDE (INT. and EXT.)

Dual layer chain guide design ensures accurate chain entry into the load sprocket. Manufactured from wear-resistant material with high-temperature treatment provides long-term durability.

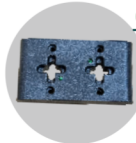

DIMENSIONS

Model	Capacity [kg/lb]	Hmin [mm/in]	A [mm/in]	B [mm/in]	C [mm/in]	D [mm/in]	E [mm/in]	F [mm/in]	G [mm/in]	K [mm/in]	Body Weight [kg/lb]
XL2-10SC	1000/2205	600/23-5/8	206/8-1/8	231/9-1/8	145/5-11/16	142/5-9/16	133/5-1/4	44/1-3/4	146/5-3/4	31/1-1/4	29/64
XL3-10SC	1000/2205	585/23-1/16	239/9-7/16	266/10-1/2	169/6-5/8	166/6-9/16	150/5-7/8	44/1-3/4	167/6-9/16	31/1-1/4	47/104
XLL-05SC	500/1102	600/23-5/8	206/8-1/8	231/9-1/8	145/5-11/16	142/5-9/16	133/5-1/4	44/1-3/4	146/5-3/4	31/1-1/4	26/57

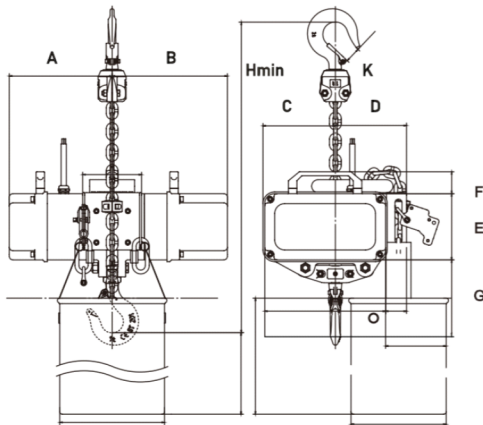

OPTIONAL FEATURES

INTEGRATED LOADCELL

Display real-time position coordinates and speed.

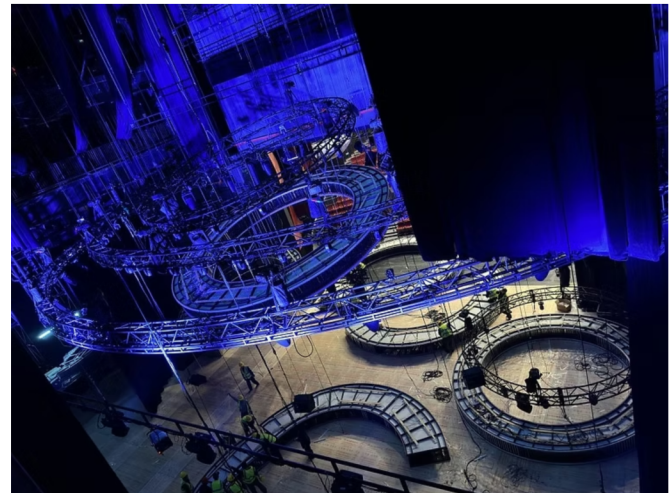

CONTROL COMPATIBILITY

7-pin motor connector for power and control, plus 4-pin XLR (24V) low-voltage control interface for compatibility with common entertainment control systems.

ROAD CASE DIMENSION AND WEIGHT

XL2-10SC: 530x490x600mm/20-7/8"×19-5/16"×23-5/8", 21.5 kg/47.40 lb
XL3-10SC: 700x590x740mm/27-9/16"×23-1/4"×29-1/8", 35 kg/77.16 lb
XLL-05SC: 530x490x600mm/20-7/8"×19-5/16"×23-5/8", 21.5kg/47.40 lb



usoffice@gstgr.com
USA: +1-702-881-8880

www.gstgr.com

© 2022 GST Gear LLC. All Rights Reserved.